



ARMADILLO

tow it, place it, secure it



armadillo - tow it, place it, secure it.

ROAD TOWABLE WELFARE

The **armadillo** is towable by a wide range of vehicles from traditional transits to modern pick-ups.



The **NEW armadillo** mobile welfare cabin from Garic is a road towable, self-contained unit large enough for a workforce of up to six (or ten - see page 8). It can be towed into position, placed and then secured making it ready for use in less than five minutes after arrival on site. It doesn't matter how remote your site location is, once the **armadillo** is put in place you can be safe in the knowledge that it will stay put!

As manufacturers, Garic are confident that all our **armadillo** cabins can be adapted or modified to suit any of your individual needs. The **armadillo** is available in two industry standard sizes, has additional features and a better price comparison to similar products on the market.

Want to know more? Then give us a call on **0161 766 8808**.



Armadillo 10



...**wherever** the job, **whatever** the weather



armadillo - it's as easy as... **one, two, three!**

Minimum Hire Period • **JUST ONE WEEK** • Minimum Hire Period



STAGE 1

Manoeuvre the **armadillo** into its required position, this can be done by towing vehicle or by hand if necessary. Using the simple controller, raise the **armadillo** on hydraulic jacks until the wheels are clear of the ground. Collapse the tow bar and release the axle lock.



STAGE 2

Once the tow bar has been fully collapsed and the axle released using the simple slide lever, the **armadillo** can then be lowered to the ground using the hydraulic controller. When fully lowered the wheels will be fully hidden beneath the cabin.



STAGE 3

When fully lowered the tow bar cover can be released and positioned. Once the locking mechanism has been engaged the **armadillo** is secured and ready for use. Simply fire up the generator and you're ready to go all within minutes of your arrival on site.

where you need it, **when** you need it.



PART OF THE TEAM

The armadillo is just one member of the Garic mobile welfare team. We have everything you might need from our transit, which combines transport and welfare for up to seven, right up to 40ft trailers which can be offices, canteens, toilets, even sleeper units. So give us a call, we're sure to have just what you need for your team.



call 0161 766 8808



The **armadillo** is the mobile welfare cabin with everything you need. The main mess area has seating for ten, microwave and kettle. Thermostatically controlled heating (including automatic frost protection) means a comfortably warm environment is always guaranteed.

- 1 The main cabin has bench seating for up to ten around the table, steel shuttered window, heating (with auto-frost protection) and lighting.
- 2 The private toilet area has flushing wc, forearm sink and independent heating and lighting.
- 3 The mess area features microwave, kettle and drinking water supply along with sink and drainer.
- 4 Sinks in both the main cabin and toilet have hot and cold running water and soap dispenser.
- 5 The generator/drying room has independent lighting and garment hooks.

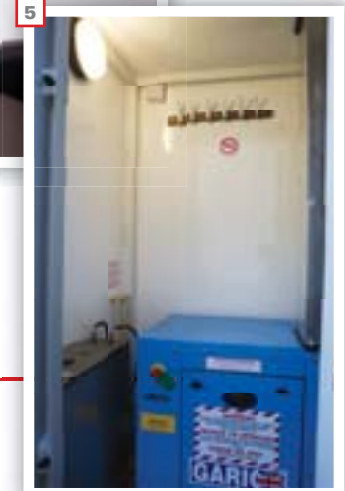

specification and dimensions

LOCKABLE COVER

Can be locked in both the 'up' position when being towed and the 'down' position when the **armadillo** has been securely positioned.

STEEL CONSTRUCTION

Outer skin made from heavy duty steel keeps out unwelcome visitors.



TOW BAR

Pin and hitch tow bar with jockey wheel. Collapses flat and is fully covered by the lockable cover.

BUILT IN HOUSE

At Garic we manufacture our armadillo from scratch allowing us to offer a bespoke design service to match client specifications.



Features and capacities	Armadillo 6
Private toilet wc with hot and cold running water	✓
Generator / drying room	✓
Table and padded bench seating	✓
Microwave and water boiler / kettle	✓
Heating control and lighting	✓
Washing sink with hot and cold running water	✓
Frost protection system	✓

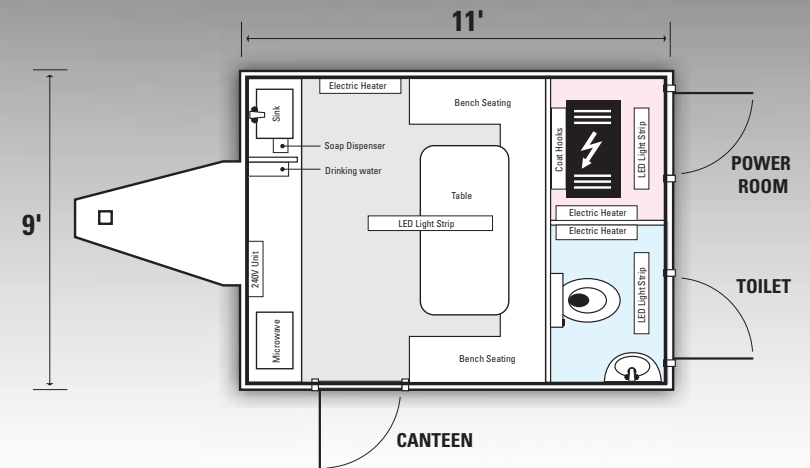

Above is the layout for the 'off-the-shelf' version of the six man **armadillo**. As each **armadillo** is built from scratch by us, if you have **specific requirements** from your welfare cabin, the **armadillo** can be modified to suit your needs.

call 0161 766 8808



armadillo - go large with the armadillo 10

Why 'GO LARGE' with the armadillo 10?

We have taken the armadillo 6 and increased the footprint to accommodate up to 10 people in a secure, economic and self contained welfare cabin environment.

We call it the **armadillo 10**, it has all the same features of the 6 but now you have an option to '**go large**'. Due to the twin axle design and its strengthened load-bearing chassis the **armadillo 10** is a great choice for contractors and companies who need a quick onsite welfare solution.

All the standard features you find in the armadillo 6 are present in the 10, such as solar lighting, private WC with hot water and cold running water, frost protection, microwave, table and seating for 10 people.

If you have a specific requirement we can customise the armadillo to suit your specific needs.

Want to '**go large**'?

Then give us a call on **0161 766 8808**.



Minimum Hire Period • **JUST ONE WEEK** • Minimum Hire Period



...goes **anywhere** and **stays there!**



specification and dimensions

The **armadillo 10** has all the same equipment as the **armadillo 6** but with room for ten in the canteen; overall it is 5 metres long (instead of 3.6m) and has a twin axle.

If you have **specific requirements** from your welfare cabin the **armadillo** can be modified to suit your needs.



Features and capacities	Armadillo 10
Private toilet wc with hot and cold running water	✓
Generator / drying room	✓
Table and padded bench seating	✓
Microwave and water boiler / kettle	✓
Heating control and lighting	✓
Washing sink with hot and cold running water	✓
Frost protection system	✓

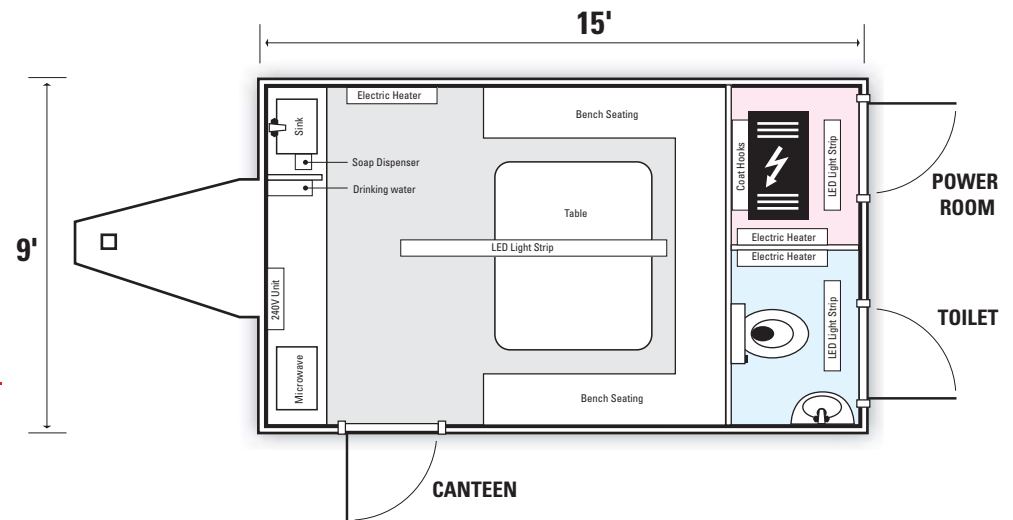



GENERATOR/DRYING ROOM

Houses super silent generator, has independent LED lighting and coat hooks for drying clothing.

STEEL SHUTTERED WINDOW

Locked from the inside for increased security when not in use.

TWIN AXLE

Can be locked in both the 'down' position when being towed and the 'up' position when the **armadillo** has been securely positioned.

TOILET

Private, fully flushing toilet with hot and cold running water, heating and independent LED lighting.



call 0161 766 8808



Kingfisher Park, Aviation Road, Pilsworth, Bury, Lancashire BL9 8GD
T +44 (0) 161 766 8808 **F** +44 (0) 161 766 8809 **E** info@garic.co.uk **www.garic.co.uk**

